

Mosmatic car wash ceiling booms

Mosmatic standard



360°

Stainless steel. Ceiling boom with ball bearing swivels. Maintenance-free. Connection with swivel. Max. 275 bar / 90 °C

R+M Nr.	↔	⊙	⊚	⊠
109 717	1750 mm	1/4" F	1/4" M	10,5 kg

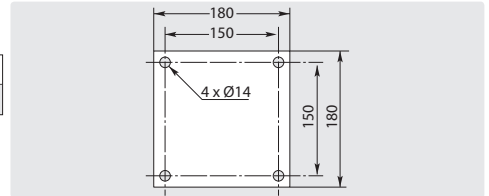

Mosmatic car wash ceiling boom-Z with insulated high pressure hose



360°

Stainless steel. Ready for installation with two integrated swivels. Especially designed for using two booms side by side. Insulated high pressure hose. Max. 275 bar / 90 °C.

Attention: Delivery time of approx. 2 week!

R+M Nr.	↔	⊙	⊚	⊠
108 650 11	1550 mm	1/4" F	1/4" M	9,9 kg

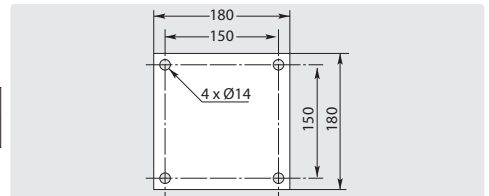

Mosmatic double ceiling booms with insulated high pressure hoses



360°

Stainless steel. Ready for installation with three integrated swivels, professional high pressure hose with spring and integrated hose bend restrictors. Axle 2-ball bearings and permanently lubricated. Especially developed for 2 different application mediums. Max. 275 bar / 90 °C.

Attention: Delivery time of approx. 2 week!

R+M Nr.	↔	⊙	⊚	⊠
108 674 23	1750 mm / 1900 mm	1/4" F	1/4" M	19,2 kg
108 674 33	1900 mm / 2050 mm	1/4" F	1/4" M	19,5 kg
108 674 43	2050 mm / 2250 mm	1/4" F	1/4" M	19,8 kg
108 674 53	2250 mm / 2500 mm	1/4" F	1/4" M	21,1 kg

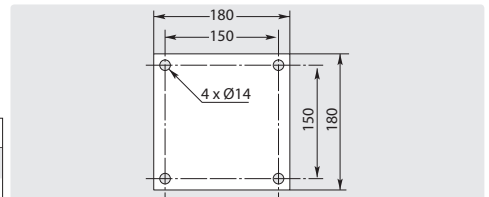

Wall mounts



Stainless steel V2A / AISI 304. For **easywash365+** and Mosmatic ceiling booms

R+M Nr.
109 721 047

Positioner



Positioner with solenoid. By means of a positioning device the Mosmatic ceiling boom-Z can easily be parked in the desired position.

R+M Nr.
108 659 11

Spare spring

easywash365+

Spring for **easywash365+** ceiling booms

R+M Nr.
108 901 858

Mosmatic

Spring for Mosmatic ceiling booms

R+M Nr.
108 375 70

Replacement hoses

easywash365+

Hoses for **easywash365+** ceiling booms

R+M Nr.	↔
340 114 400 099 49	800 mm
340 114 400 169 49	1550 mm
340 114 400 174 49	1600 mm
340 114 400 189 49	1750 mm
340 114 400 203 49	2050 mm

Mosmatic

Hoses for Mosmatic ceiling booms

R+M Nr.	↔
346 176 001 67	1550 mm
346 176 001 72	1600 mm
346 176 001 87	1750 mm
346 176 002 00	1900 mm
346 176 002 15	2050 mm
346 176 002 35	2250 mm
346 176 002 60	2500 mm